

Smart Vision

Accurate Data in Real Estate



www.smartvisionn.com



KATRE
ADVERTISING



- Capture 3D spaces effortlessly in minutes using your smartphone or tablet.
- With the Smart Vision app, you can easily scan residential and commercial properties to create accurate 3D models that transform into customizable 2D/3D floor plans, measurement reports, and point calculations in various formats. Simply press the scan button — and let our advanced technology work its magic.



Speed

Scan 150 m² spaces in under 15 minutes.

Cost-effective

All you need is a mobile device.

Simple

Anyone can perform the scan.



- Downloadable 3D Model Feature
By eliminating the errors caused by the limitations of 2D photography, we provide comprehensive access to apartments from every possible perspective in 3D.

With Smart Vision, anyone can effortlessly create 3D models through the app—no training required.

Create as many models as you want, completely free of charge.

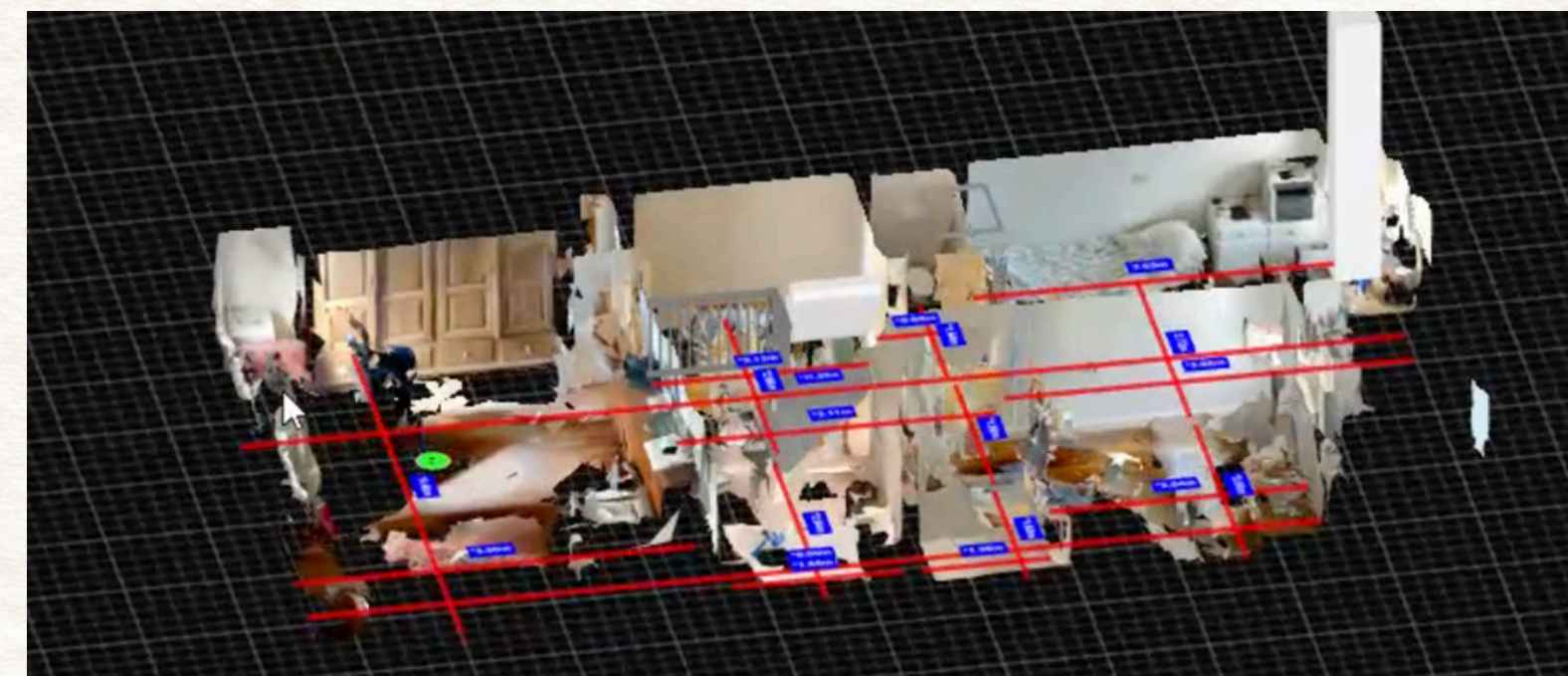
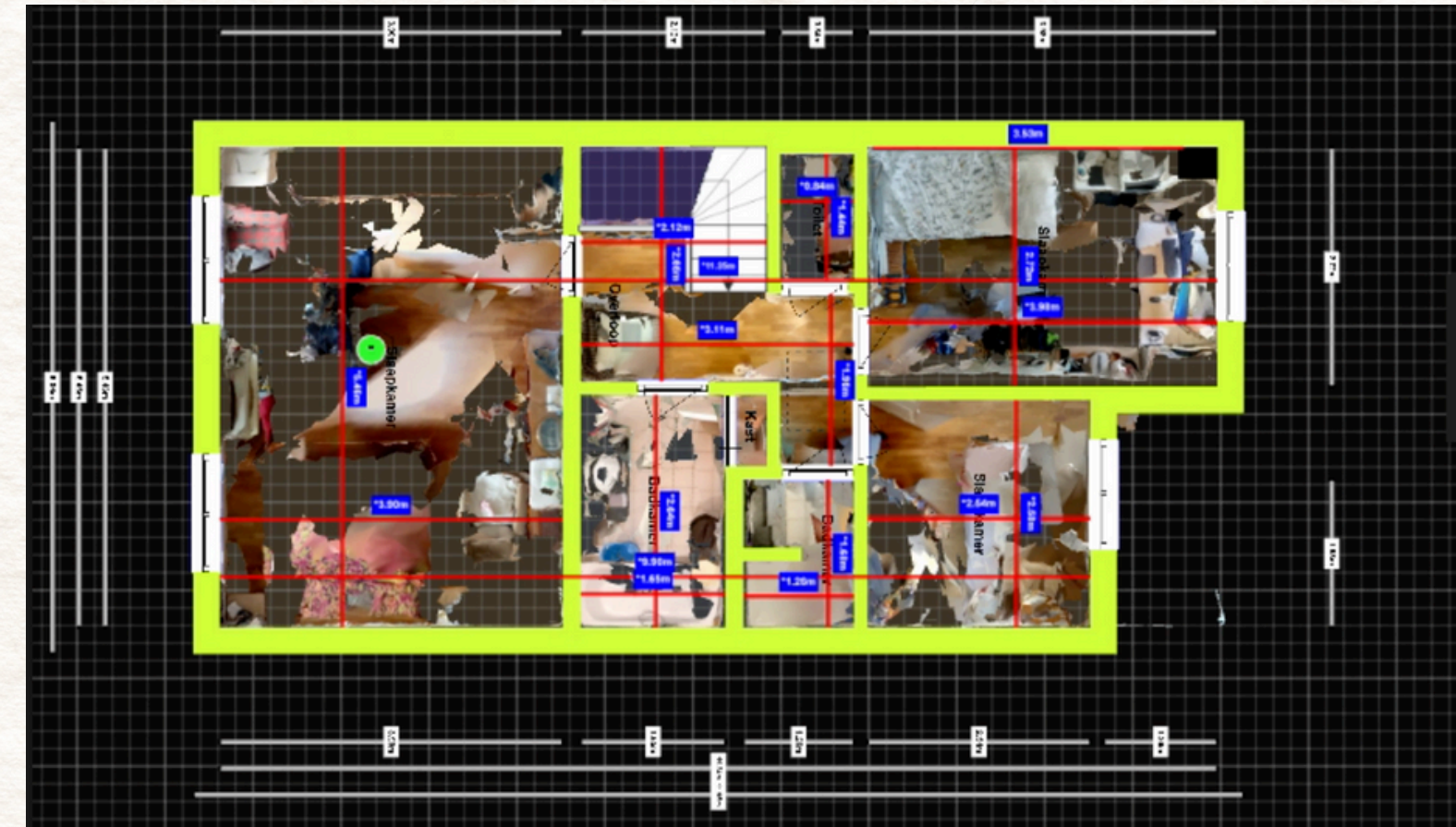

- Accurate Floor Plans and Measurement Reports
- Obtain precise 2D or 3D plans and measurements for both residential and commercial properties.
- All plans are customized to match your property's style and delivered within 2 hours.
- No need to hire a professional draftsman — our software does it all for you.



- With the Smart Vision app, apartments that have been scanned and converted into floor plans can be easily enhanced with room photos, balcony or room views, material details, and virtual tour features — all directly within the app.
- Visitors can explore the property room by room, view it from different angles, and instantly navigate to any point they desire with just one click.

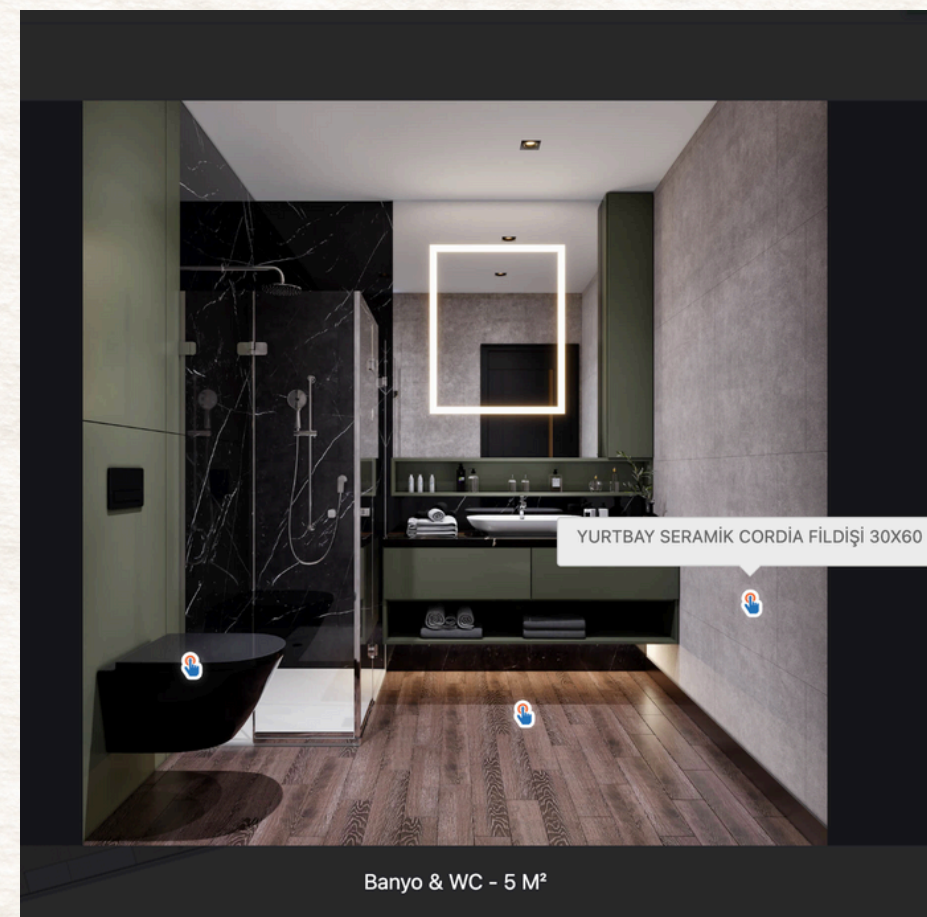
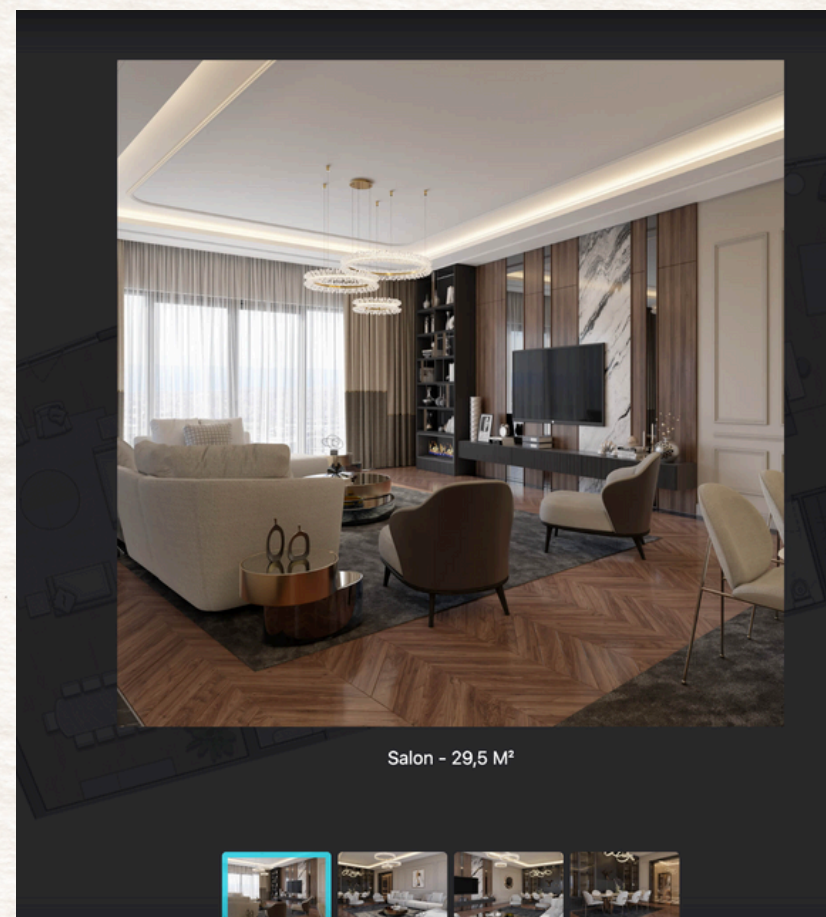

- With the Parcel Inquiry feature, you can quickly access the block/parcel information of any property in the city and examine its zoning status and ownership details in depth. The Urban Construction Guide module provides access to numerous technical details — from building conditions to planning notes — allowing users to understand the city’s development dynamics.

Google Maps integration enables instant location-based analysis of an apartment or commercial property, helping you evaluate its surrounding environment directly on the map.

The Reports section allows you to export all your inquiries and analyses as PDF or Excel summaries for easy reference and sharing.

1.**PARCEL INQUIRY****2****URBAN CONSTRUCTION
GUIDE****3.****GOOGLE MAPS****4.****REPORTS**

➤ **PROPERTY VALUATION**

The Smart Vision application aims to provide a realistic and up-to-date valuation process by analyzing multiple parameters such as property location, zoning status, environmental factors, market conditions, and comparable property data — forming the foundation for making informed decisions in real estate investments through reliable valuation.





- With the CRM (Customer Relationship Management) system, you can centralize all customer data on a single platform, analyze past interactions, and deliver more personalized service experiences.

Integrated chatbots provide customers with 24/7 uninterrupted support, enhancing satisfaction and conversion rates through instant response mechanisms. Through AI-powered customer analytics, you can gain deep insights into user behavior and better understand your target audience.

Based on this data, automated marketing strategies reach the right audience at the right time — reducing marketing costs while maximizing sales performance.

1.

CRM

2

CHATBOTS

3.

**AI-POWERED CUSTOMER
ANALYSIS**

4.

**AUTOMATED MARKETING
STRATEGIES**



Accurate Data in Real Estate

Thank you.

A search bar with a magnifying glass icon on the left and a close 'x' icon on the right. The text "www.smartvisionn.com" is entered in the center.